

Refer to
controller's wiring
diagram for details

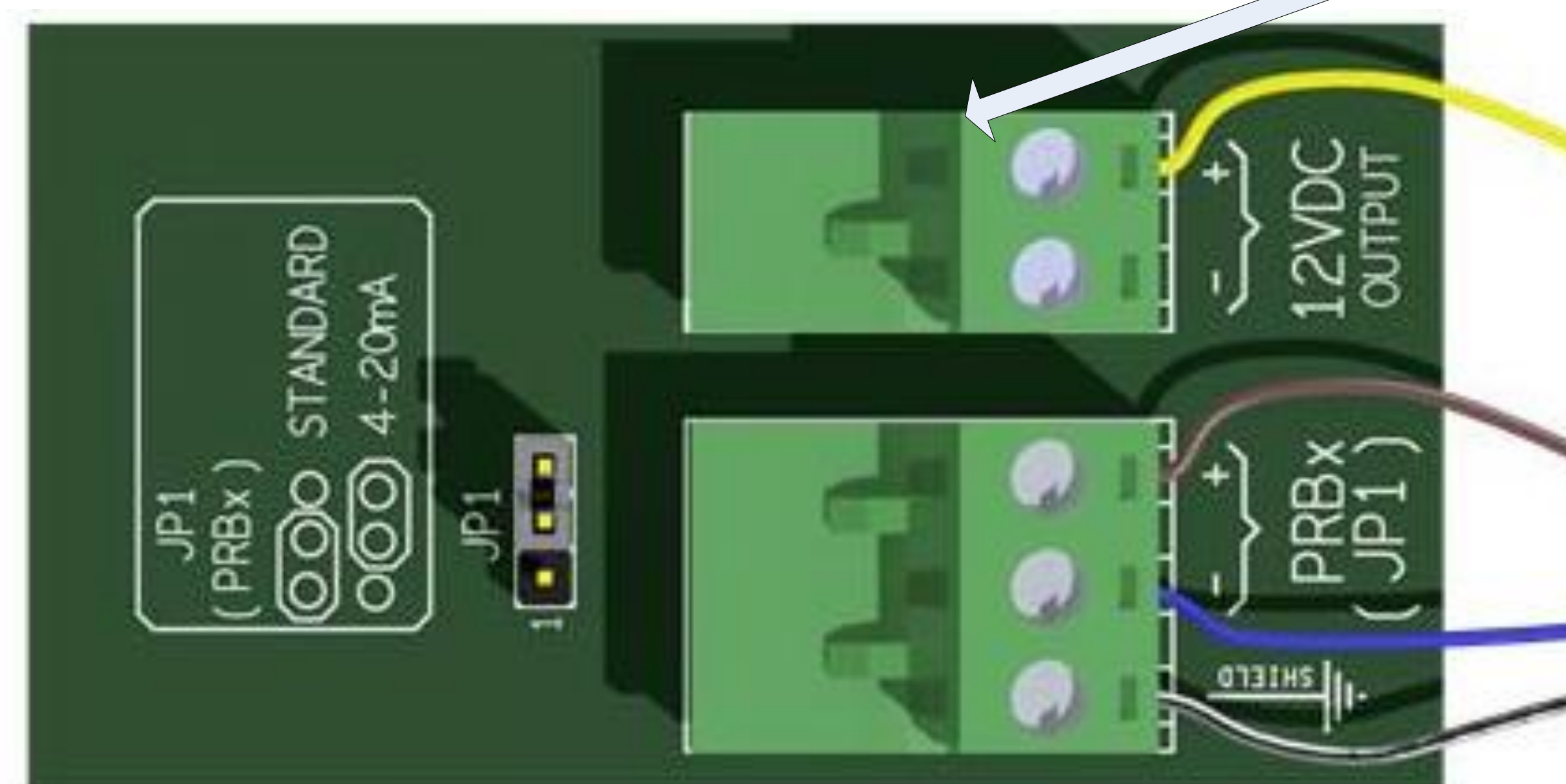

GE-PRESS+/420 product
sheet v1.2



Product description

The GE-PRESS+/420 static pressure probe is a precise measuring tool used to measure the pressure difference between 2 rooms or between a building’s interior and the exterior. This probe is the ideal solution for all applications requiring static pressure and air flux readings.

Notable features of the GE-PRESS+/420 include:

- Easy installation
- Reliable readings
- Rugged, durable fabrication

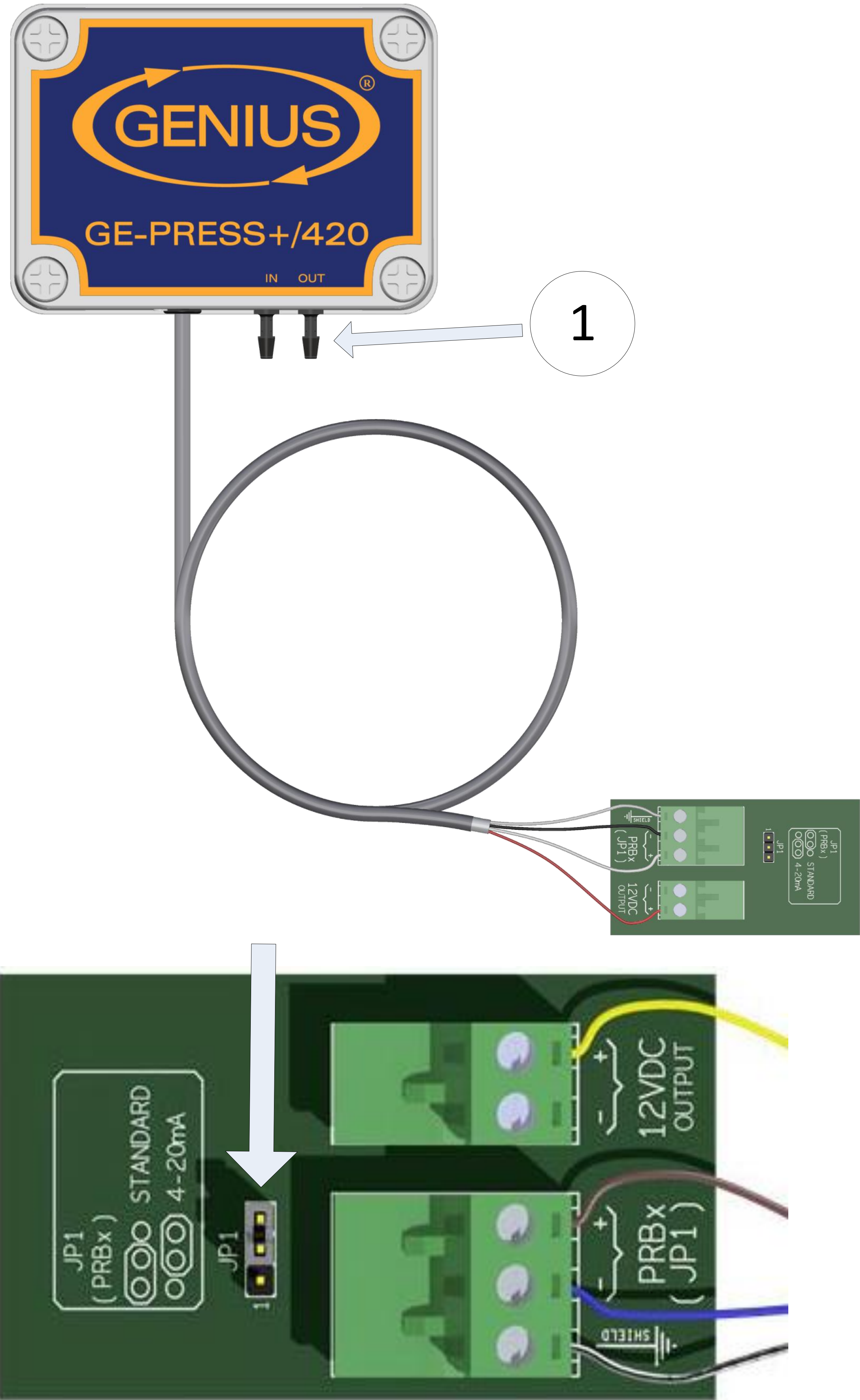

Installation

The GE-PRESS+/420 should be installed according to the installation diagram provided on the reverse side of this product sheet.

It is recommended to install the unit in a hallway to limit the GE-PRESS+/420 exposure to noxious gases. Do not install in the breeding room.

In order to avoid condensation problems inside the GE-PRESS+/420, it is recommended to install the GE-PRESS+/420 on an inside wall. If it is not possible, use spacers to have an air gap between the wall and the GE-PRESS+/420.

It is required to install the GE-PRESS+/420 **vertically** (IN/OUT tubes must be facing down) in order to limit the impact of gravity on the sensor diaphragm.

The cables and tubes of the probe must be facing down in order to avoid humidity getting into the probe.

To secure the probe tubes, use tie-wraps. Refer to the image (1).

The GE-PRESS+/420 should be installed in an easily accessible location but away from damaging elements (heat, cold, water, direct sunlight, ...).

Complete electrical connections as seen in reference (2)

Do not install the GE-PRESS+/420 near high-voltage equipment, power supplies or transformers.

The OUT tube must go to the attic space, while the IN tube must be located in the breeding room.

Do not install in the attic space.

2

JUMPER

Make sure that the installed jumper on the PRB outout of your master controller is set to 4-20 mA

Specifications

Weight

8 oz (230 g)

Tubes

3/16” (5 mm) internal ; 0.45” (9 mm) external

Temperature limits

0 °F to 150 °F (-18 °C to 66 °C)

Pressure limits

+/- 0.500 in.WC (+/- 125 Pa)

Relative humidity

90% maximum without condensation

Power requirements

120VDC

Output signal

420 mA

Current consumption

50 mA



The GE-PRESS+/420 module must never be installed outside a building. It cannot survive adverse weather effects and is meant for interior use only. **INSTALLING THE GE-PRESS+/420 SYSTEM OUTSIDE A BUILDING, OR IN AN AREA WHERE IT IS EXPOSED TO WEATHER EFFECTS, WILL VOID THE WARRANTY.**

GE-PRESS+/420 product sheet V1.2

